



THE TOWN OF
Holly Springs
NORTH CAROLINA
Engineering Department

Comprehensive Transportation Plan

FIGURE 4.2B
Pedestrian Companion Map

- Proposed Sidewalk
- Existing Sidewalk
- Proposed Greenway
- Existing Greenway
- Parks

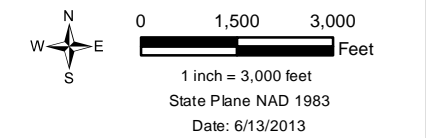
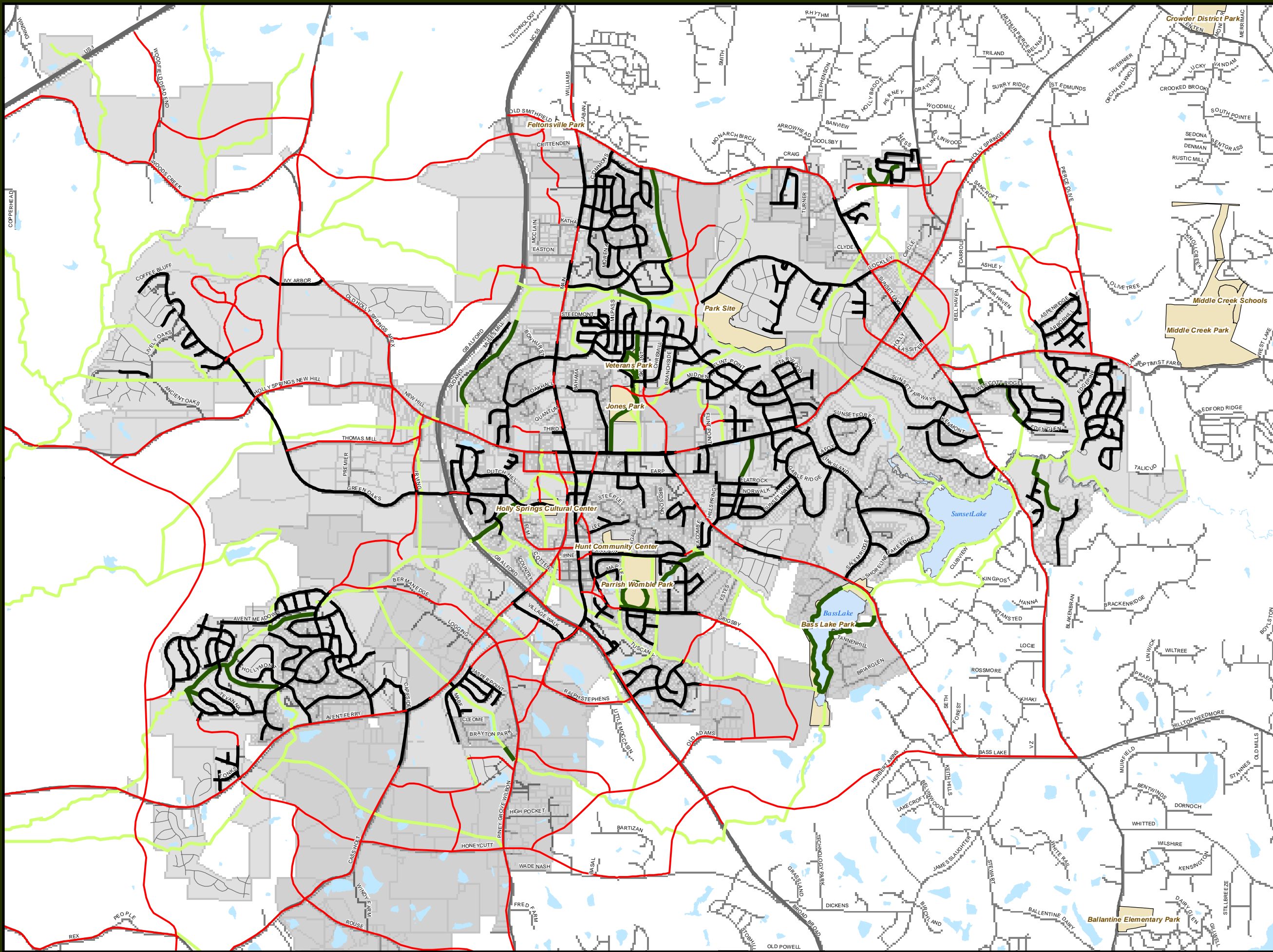

For More Information contact:
 Town of Holly Springs
 Engineering Department
 P.O. Box 8
 Holly Springs, NC 27540
 919.557.3926
 www.hollyspringsnc.us

The Town expressly denies any and all responsibility for errors, if any, in the information/data or for the misuse of the information/data by the user or anyone else. The user understands that he or she should verify the accuracy of the information/data before using it.